



SRI PENAWAR

@ DESARU

SINGLE STOREY TERRACE HOUSE

单层排屋

20' x 70'



OPEN FOR REGISTRATION

MASTERPLAN OF TAMAN SRI PENAWAR

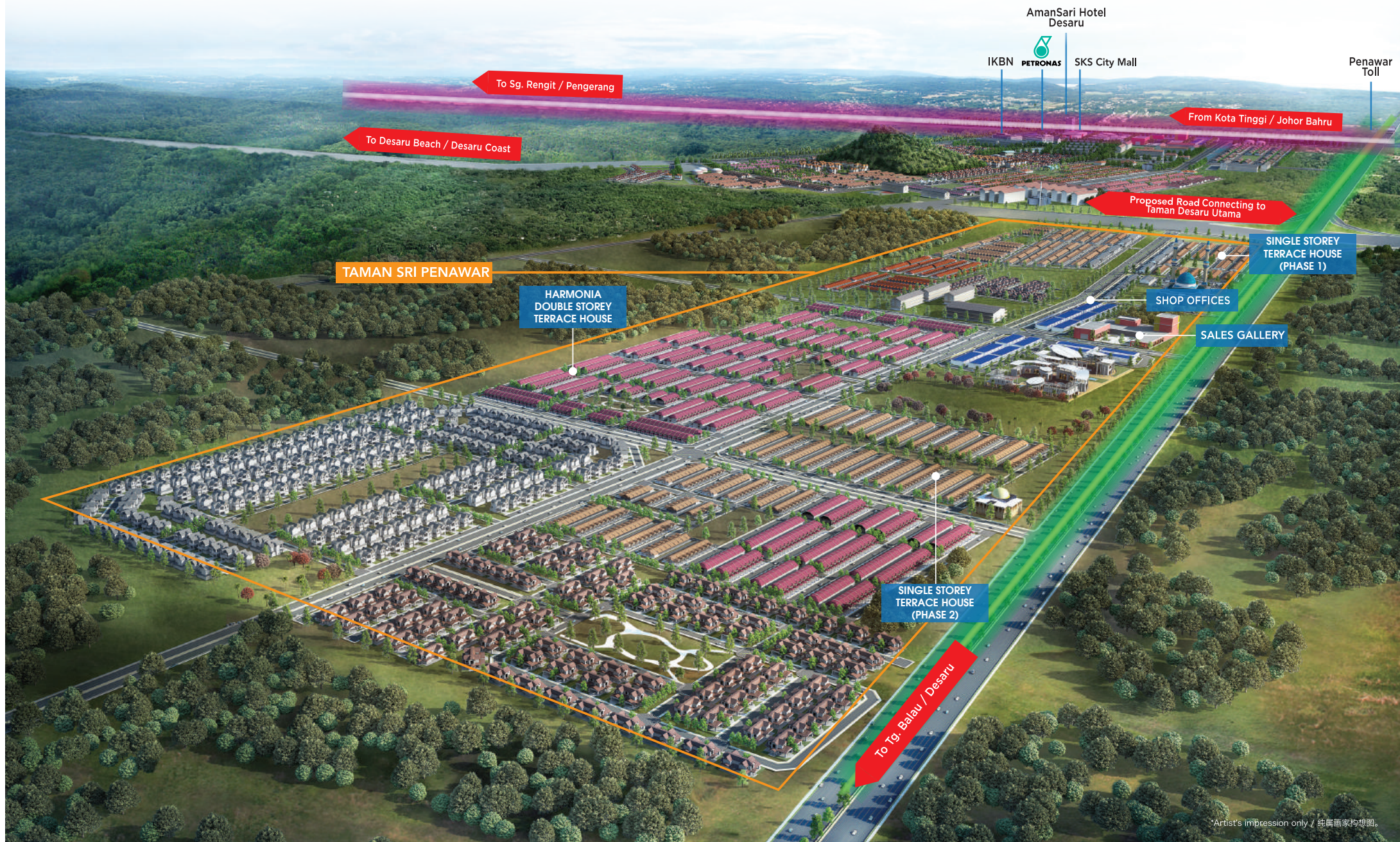



SRI PENAWAR
@ DESARU

Single Storey Terrace House 单层排屋

Standard Land Area 标准土地面积: 20' x 70'

Standard Built-up Area 标准建筑面积: 1,113sq. ft. 平方英尺

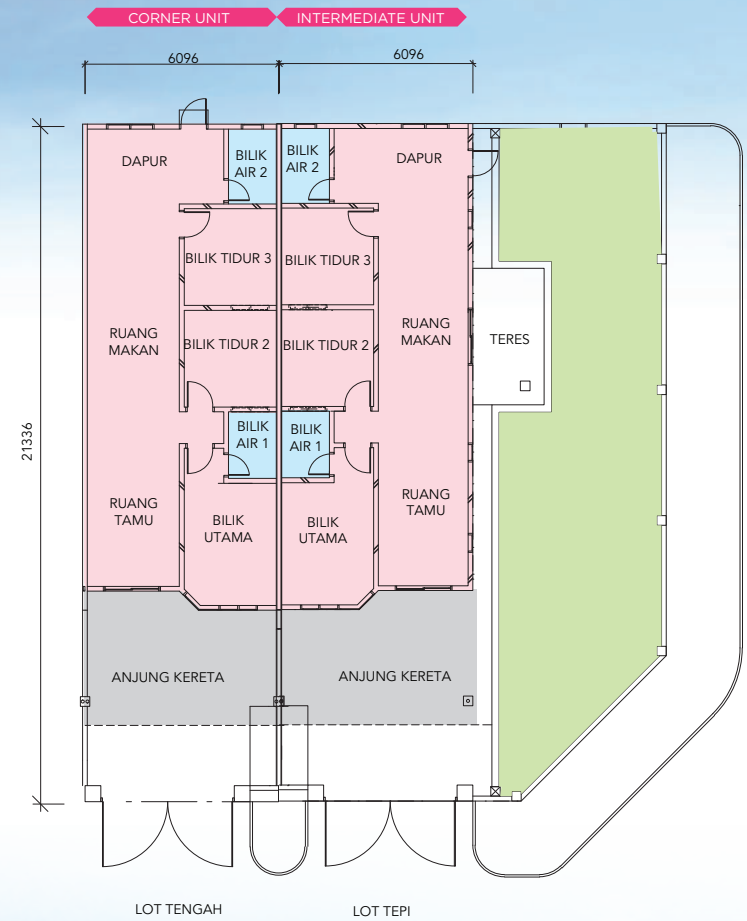

*Artist's impression only / 纯属画家构想图。



邻近景点与发展项目

ATTRACTIONS & DEVELOPMENTS within the vicinity

Located on Johor's eastern coast, Desaru in Kota Tinggi district is a popular holiday destination among locals and tourists. **Taman Sri Penawar** with its prime location in Desaru, is a modern township with great growth potential, connecting seamlessly to tourist attractions, colleges and major developments.

迪沙鲁坐落于柔佛州东海岸哥打丁宜县，向来广受本地与海外游客的青睐。**Taman Sri Penawar** 占据迪沙鲁黄金地段，交通便捷衔接各旅游景点、学院以及主要投资项目，是发展潜力无穷的新兴城镇。

For Enquiry: **012-757 1708** SYAMSILLA **013-747 3709** HIDAYATI **017-720 8987** SHAIERA **017-732 1177** SALES GALLERY



Developer: Cocoa Valley Development Sdn Bhd (1178919-P)
A Subsidiary of MB World Group Berhad
Unit 5-01, Level 5, Plaza DNP, No. 59, Jalan Dato' Abdullah Tahir, 80300 Johor Bahru, Johor.
T: +607-330 5979 F: +607-330 5971 W: www.mbworld.com.my

* Project Name: Taman Sri Penawar Single Storey Terrace House (Serenita) • Developer's License No.: 14589-7/02-2020/0146(L) • Valid: 09/02/2018 – 08/02/2020 • Advertisement & Sale Permit No.: 14589-7/02-2020/0146(P) • Valid: 09/02/2018 – 08/02/2020 • Expected Date of Completion: December 2020 • Building Plans Approving Authority: Lembaga Bandaran Johor Tenggara • Building Plans Approval No.: PB/ZP/B5/2016 • Land Tenure: Leasehold (Until 6 December 2115) • Encumbrances: OCBC Bank (Malaysia) Berhad • Total Units: 166 • Price (min): RM350,000 • Price (max): RM587,720

* Note: All renderings, illustrations, photographs, furniture, displayed units, landscape amenities or accessories are shown for illustrative purposes only and do not represent the actual design, physical or structural details of the building and/or denote any legal representations. Plans, specifications, materials, unit numbers, address, name of project and other information contained herein are intended to give a general indication of the proposed design only and are subject to change and/or amendments as may be required by the Developer or as directed by the relevant authorities/ architect. All areas and other measurements are approximate only and subject to final survey. All statements are believed to be correct but are not to be regarded as representation of facts. While every reasonable care has been taken in preparing this website/publication/banner/poster and in constructing the scale models and sales gallery/show unit, the Developer and its related companies, representatives, consultants and agents accept no responsibility for any inaccuracies or omissions. The Sale and Purchase Agreement embodies all the terms and conditions between the Developer and the purchasers, and supersedes and cancels all previous representations, warranties, promises, inducements or statements of intention, whether in written, oral or visual made by the Developer and/or its agents which are not embodied in the Sale and Purchase Agreement. Interested persons should rely on their own inquiries.



SEAMLESS CONNECTIVITY

- To JB city centre, Senai International Airport and Iskandar Puteri via Senai-Desaru Expressway
- Tanjung Belungkor ferry terminal for convenient access to Changi, Singapore

THRIVING INDUSTRIES

- Bio Desaru
- Pengerang Integrated Petroleum Complex (PIPC)
- Refinery and Petrochemical Integrated Development (RAPID)

TOURIST ATTRACTIONS

- Desaru Fruit Farm
- Desaru Ostrich Farm
- Desaru Firefly River Cruise
- Fishermen Museum
- Sg. Rengit Fishing Village
- Upcoming Desaru Coast with world class hotel, water theme park and conference centre

EDUCATION HUB

- Institut Sains dan Teknologi Darul Takzim (INSTEDT)
- Institut Kemahiran Belia Negara (IKBN)
- Kolej Profesional MARA
- Kolej Komuniti Bandar Penawar
- Bandar Penawar Sports School

交通便捷

- 经士乃/迪沙鲁大道轻易前往新山市中心，士乃国际机场及依斯干达公主城
- 渡轮码头方便前往新加坡樟宜

繁华工业

- 迪沙鲁有机农业谷
- 边加兰石化综合中心 (PIPC)
- 石油化学综合发展计划 (RAPID)

旅游景点

- 迪沙鲁果园，迪沙鲁鸵鸟园，迪沙鲁萤火虫游船，渔夫博物馆，四湾岛渔村，迪沙鲁海滨世界级酒店，水上主题乐园及会议中心

教育中心

- INSTEDT 学院，国家青年技术学院，玛拉专业学院，本那瓦社区学院，体育学校

SALES GALLERY
TAMAN SRI PENAWAR
SALES GALLERY OPENS DAILY
10am to 5pm
(Except for Public Holidays)

